

## FEATURES & SPECIFICATIONS

### INTENDED USE

Provides years of maintenance-free general illumination for outdoor use in commercial applications such as retail, education, multi-unit housing and storage. Ideal for lighting building facades, parking areas, walkways, garages, loading areas and any other outdoor space requiring reliable safety and security.

### CONSTRUCTION

Sturdy weather-resistant aluminum housing with a bronze finish, standard unless otherwise noted. A clear polycarbonate lens protects the optics from moisture, dirt and other contaminants.

### OPTICS

8 high performance LEDs are powered by a multi-volt (120V-277V) LED driver that uses 18 input watts and provides 1,490 delivered lumens. 100,000 hour LED lifespan based on IESNA LM-80-08 results and calculated per IESNA TM-21-11 methodology.

### ELECTRICAL

Rated for outdoor installations, -40°C minimum ambient.

Adjustable Dusk-to-dawn, multi-volt photocell standard automatically turns light on at dusk and off at dawn for convenience and energy savings.

Photocell can be disabled by rotating the photocell cover.

6KV

Surface or recessed mount. A universal junction box is included standard.

All mounting hardware included.

### LISTINGS

UL Certified to US and Canadian safety standards. Wet location listed for mounting higher than 4 feet off the ground.

Tested in accordance with IESNA LM-79 and LM-80 standards.

### WARRANTY

5-year limited warranty. Complete warranty terms located at

[www.acuitybrands.com/CustomerResources/Terms\\_and\\_conditions.aspx](http://www.acuitybrands.com/CustomerResources/Terms_and_conditions.aspx)

Actual performance may differ as a result of end-user environment and application.

Note: Specifications subject to change without notice.

Catalog Number
Notes
Type

Outdoor General Purpose

# OLW14

LED WALL PACK

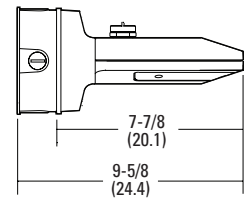
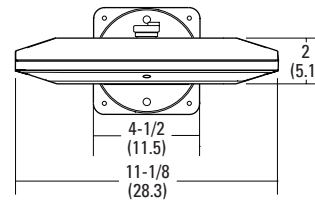

All dimensions are inches (centimeters) unless otherwise indicated.

### ORDERING INFORMATION

For shortest lead times, configure product using **bolded options**.

Example: OLW14

Series	Color temperature (CCT) <sup>1</sup>	Voltage	Control	Finish
<b>OLW14</b> 1400 lumen LED wall pack	<b>(blank)</b> 5000K <sup>1</sup>	<b>(blank)</b> MVOLT (120V-277V)	<b>(blank)</b> MVOLT photocell included	<b>(blank)</b> Bronze WH White

**Accessories:** Order as separate catalog number.

FCOS M24	Full cutoff shield
FCOS WH M24	Full cutoff shield, white

### Notes

<sup>1</sup> Correlated Color Temperature (CCT) shown is nominal per ANSI C78,377-2008.

## PHOTOMETRIC DIAGRAMS

Full photometric data report available within 2 weeks from request. Consult factory. Tested in accordance with IESNA LM-79 and LM-80 standards.

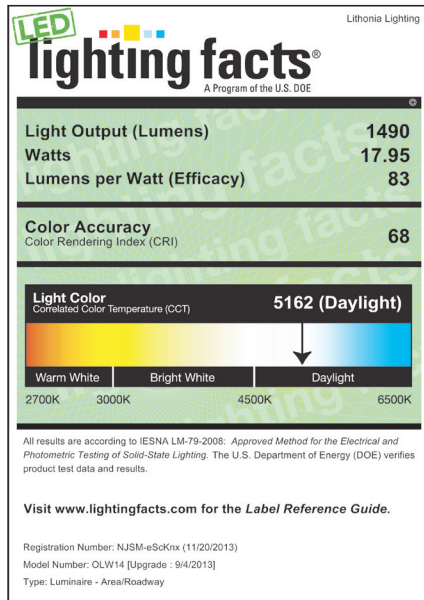

## FEATURES & SPECIFICATIONS

### INTENDED USE

Provides years of maintenance-free general illumination for outdoor use in commercial applications such as retail, education, multi-unit housing and storage. Ideal for lighting building facades, parking areas, walkways, garages, loading areas and any other outdoor space requiring reliable safety and security.

### CONSTRUCTION

Sturdy weather-resistant aluminum housing with a bronze finish, standard unless otherwise noted. A clear polycarbonate lens protects the optics from moisture, dirt and other contaminants.

### OPTICS

8 high performance LEDs are powered by a multi-volt (120V-277V) LED driver that uses 18 input watts and provides 1,490 delivered lumens. 100,000 hour LED lifespan based on IESNA LM-80-08 results and calculated per IESNA TM-21-11 methodology.

### ELECTRICAL

Rated for outdoor installations, -40°C minimum ambient.

Adjustable Dusk-to-dawn, multi-volt photocell standard automatically turns light on at dusk and off at dawn for convenience and energy savings.

Photocell can be disabled by rotating the photocell cover.

6KV

Surface or recessed mount. A universal junction box is included standard.

All mounting hardware included.

### LISTINGS

UL Certified to US and Canadian safety standards. Wet location listed for mounting higher than 4 feet off the ground.

Tested in accordance with IESNA LM-79 and LM-80 standards.

### WARRANTY

5-year limited warranty. Complete warranty terms located at

[www.acuitybrands.com/CustomerResources/Terms\\_and\\_conditions.aspx](http://www.acuitybrands.com/CustomerResources/Terms_and_conditions.aspx)

Actual performance may differ as a result of end-user environment and application.

Note: Specifications subject to change without notice.

Catalog Number
Notes
Type

Outdoor General Purpose

# OLW14

LED WALL PACK

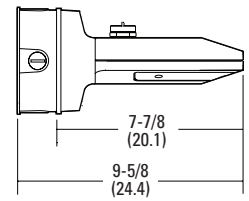
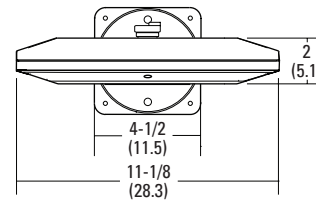

All dimensions are inches (centimeters) unless otherwise indicated.

### ORDERING INFORMATION

For shortest lead times, configure product using **bolded options**.

Example: OLW14

Series	Color temperature (CCT) <sup>1</sup>	Voltage	Control	Finish
<b>OLW14</b> 1400 lumen LED wall pack	<b>(blank)</b> 5000K <sup>1</sup>	<b>(blank)</b> MVOLT (120V-277V)	<b>(blank)</b> MVOLT photocell included	<b>(blank)</b> Bronze WH White

**Accessories:** Order as separate catalog number.

FCOS M24	Full cutoff shield
FCOS WH M24	Full cutoff shield, white

### Notes

<sup>1</sup> Correlated Color Temperature (CCT) shown is nominal per ANSI C78,377-2008.

## PHOTOMETRIC DIAGRAMS

Full photometric data report available within 2 weeks from request. Consult factory. Tested in accordance with IESNA LM-79 and LM-80 standards.

