

Couplings - Zinc

Images

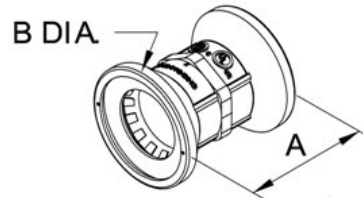

Application

The 261-MB is used to couple two properly deburred lengths of 3/4" EMT raceway. Simply push the fitting on a raceway with a slight twist. Remove the fitting by unthreading it from the conduit end. No tools are required. Dry Locations Only. Concrete Tight. Patented

Product Information

Material: Zinc Alloy body and locknut with steel internal components
Finish: Mirror finish/Ball Burnish

Certifications & Codes:

Federal Specification Number: A-A-50553
NEMA Standard: FB-1
UL File Number: E24001,cULus
UL Standard: 514B
UNSPSC: 39121434
Patent Number: 8,274,000; 8,487,197; 6,765,143

[Download Photo Image](#) [Download Dimensional Image](#)
Dimension A in Inches: 1.99
Dimension B in Inches: 1.50

Catalog ID: 261-MB

UPC Number: 78174723261

Description: 3/4" DRY PUSH-EMT® Coupling

Application: The 261-MB is used to couple two properly deburred lengths of 3/4" EMT raceway. Simply push the fitting on a raceway with a slight twist. Remove the fitting by unthreading it from the conduit end. No tools are required. Dry Locations Only. Concrete Tight. Patented

Trade Size: 3/4"

Country of Manufacture: USA

Std Pkg Qty: 250

Unit Qty: 25