

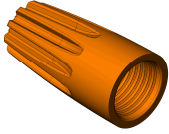

**WIRE-NUT®  
WIRE CONNECTORS**

**MODELS  
71B®, 72B®, 73B®, 74B® & 76B®**

**FEATURES/BENEFITS:**



- WIDE WIRE RANGE ENABLES USE ON VARIETY OF APPLICATIONS
- FIXED, SQUARE-WIRE SPRING CREATES ITS OWN THREADS
- MAINTAINS A SECURE CONNECTION THAT WILL NOT RELAX OVER TIME
- POSITIVE-GRIP SHELL DESIGN PROVIDES FAST, EASY INSTALLATION
- PRE-TWISTING OF WIRES IS NOT REQUIRED
- REUSEABLE FOR EASY CIRCUIT CHANGES AND ADDITIONS

**ELECTRICAL:**

VOLTAGE: 71B® / 72B® 300 VOLTS MAX.  
73B® / 74B® / 76B® 600 VOLTS MAX.\*  
  
(\* 1,000 VOLTS MAX. SIGNS & FIXTURES)

**APPLICATION TOOLS:**

- ACAM (AUTOMATIC CONNECTOR APPLICATION MACHINE)
- WIRE-NUT® Wire Connector Sockets: **30-903** (71B® & 72B®), **30-904** (73B®), **30-906** (74B® & 76B®), **H-632** (73B®, 74B® & 76B®), **30-902** (73B®, 74B® & 76B®)

**PHYSICAL:**

HOUSING: POLYPROPYLENE (UL 94V-2 FLAME RATED)  
INSERT: STEEL  
PLATING: ZINC

**STANDARDS & SPECIFICATIONS:**

UL LISTED: UL 486C  
CSA CERTIFIED: C22.2 NO. 188  
RoHS COMPLIANT



**WIRE RANGE & COMBINATIONS:**

| MODEL             | 71B® (GRAY)  | 72B® (BLUE)  | 73B® (ORANGE)   | 74B® (YELLOW)  | 76B® (RED)  |
|-------------------|--|--|---|--|---|
| WIRE RANGE:       | MIN. 2 #22 Str.<br>MAX. 2 #16  | MIN. 2 #22<br>MAX. 3 #16   | MIN. 1 #18 w/1 #20<br>MAX. 2 #14  | MIN. 2 #18<br>MAX. 4 #14 w/1 #18   | MIN. 2 #14<br>MAX. 4 #12  |
| WIRE STRIP LENGTH | Solid: 1/4" (6 mm)<br>Str: 5/16" (8 mm)  | ≤ #16 AWG: 1/2" (13 mm)<br>All Others: 3/8" (9.5 mm)   | ≤ #16 AWG: 3/8" (9.5 mm)<br>All Others: 5/16" (8 mm)  | ≤ #16 AWG: 7/16" (11 mm)<br>All Others: 3/8" (9.5 mm)  | ≤ #16 AWG: 1/2" (13 mm)<br>All Others: 7/16" (11 mm)  |
| COMBINATIONS:     | <b>300V MAX:</b><br>1 #14<br>1 or 2 #16<br>1 #18 Str.<br>1 #16 w/1 #18<br>2 #18 w/1 #20<br>2 or 3 #18<br>2 to 4 #20<br>4 #20 w/1 #22<br>2 #22 Str.<br>3 or 4 #22<br>5 #22 Sol. | <b>300V MAX:</b><br>1 #14 Str.<br>1 #16 Str.<br>1 #14 w/1 #16<br>1 #14 w/1 or 2 #18<br>2 or 3 #16<br>2 #16 w/1 #18<br>1 #18 str.<br>2 to 4 #18<br>3 to 5 #20<br>4 #20 w/1 #22<br>2 #22 | <b>600V MAX:*</b><br>1 or 2 #14<br>1 #14 w/1 or 2 #18<br>1 #16 Str.<br>1 #14 w/1 #16<br>1 #16 w/1 or 2 #18<br>2 #16<br>2 #16 w/1 #18<br>1 #18 Str.<br>1 #18 w/2 to 4 #20<br>1 #18 w3 to 4 #22<br>2 to 4 #18 | <b>600V MAX:*</b><br>1 to 3 #12<br>1 to 4 #14<br>2 to 5 #16<br>3 to 6 #20<br>2 to 5 #18<br>1 #10 w/1 #12<br>2 #12 w/1 or 2 #18<br>2 #12 w/1 or 2 #14<br>2 #14 w/1 to 3 #18<br>1 #10 w/1 or 2 #14<br>1 #12 w/1 to 3 #14 | <b>600V MAX:*</b><br>1 or 2 #10<br>1 to 4 #12<br>2 to 5 #14<br>4 to 6 #16<br>1 #16 w/4 #18<br>1 #14 w/3 or 4 #18<br>2 #14 w/2 to 4 #16<br>2 #12 w/1 to 3 #14<br>1 #10 w/1 to 3 #14<br>1 #10 w/1 or 2 #12<br>2 #10 w/1 #14 |

**DIMENSIONS:**

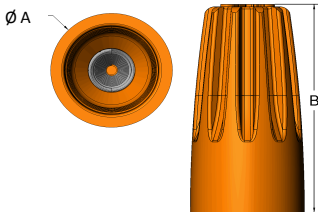

| MODEL | A      |    | B      |    |
|-------|--------|----|--------|----|
|       | INCHES | mm | INCHES | mm |
| 71B®  | 0.33   | 8  | 0.58   | 15 |
| 72B®  | 0.39   | 10 | 0.70   | 18 |
| 73B®  | 0.44   | 11 | 0.86   | 22 |
| 74B®  | 0.55   | 14 | 0.95   | 24 |
| 76B®  | 0.59   | 15 | 1.06   | 27 |

**ORDERING INFO:**

|                 | 71B® (GRAY)   | 72B® (BLUE)  | 73B® (ORANGE)   | 74B® (YELLOW)   | 76B® (RED)  |
|-----------------|---|--|---|---|---|
| CATALOG NUMBERS | <b>30-071</b> 100/Box<br><b>30-171</b> 1,000/Carton<br><b>30-271</b> 25,000/Keg<br><b>30-871</b> 150,000/Barrel | <b>30-072</b> 100/Box<br><b>30-172</b> 1,000/Carton<br><b>30-272</b> 10,000/Keg<br><b>30-872</b> 85,000/Barrel | <b>30-073</b> 100/Box<br><b>30-073J</b> 300/Jar<br><b>30-173</b> 1,000/Carton<br><b>30-273</b> 500/Bag<br><b>30-673</b> 10,000/Keg<br><b>30-873</b> 50,000/Barrel | <b>30-074</b> 100/Box<br><b>30-074J</b> 175/Jar<br><b>30-174</b> 1,000/Carton<br><b>30-274</b> 500/Bag<br><b>30-674</b> 10,000/Keg<br><b>30-874</b> 35,000/Barrel | <b>30-076</b> 100/Box<br><b>30-076J</b> 150/Jar<br><b>30-176</b> 1,000/Carton<br><b>30-276</b> 250/Bag<br><b>30-876</b> 15,000/Barrel |

**FACTORY CONTACT:**

IDEAL INDUSTRIES, INC.  
BECKER PLACE  
SYCAMORE, IL 60178  
  
PHONE: (815) 895-5181  
(800) 435-0705 in USA

**NOTES:**