

Insulators



nVent offers a full range of nVent ERIFLEX low-voltage stand-off insulators from 1 inch to 3.5 inches with a total of 29 sizes available. The cost-effective insulators offer great stability of electrical and mechanical parameters and very high resistance to leakage current.

The insulators are manufactured from a halogen-free fiberglass-reinforced thermalset unsaturated polyester molded compound (BMC). Their electro-plated zinc inserts are threaded to ASME® standards. The insulators work in temperatures from -40°F to 266°F.

- Wide range of sizes from 1 inch to 3.5 inches
- Cost effective
- cULus recognized for strength and material
- Working range of -40°F to 266°F
- High resistance to leakage current

The stand-off insulators meet the requirements of UL® 94 VO for self-extinguishing materials and are UL Recognized to Standard 891, Supplement B, Dead-front Switchboards and Accessories, 600 volt, File No. E125470. The insulators are also UL recognized for Canada for material and strength. nVent ERIFLEX insulators are the first on the market to be in compliance with the CSA® standard.

cUL[®] US

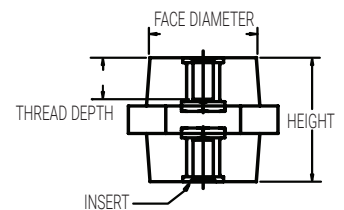
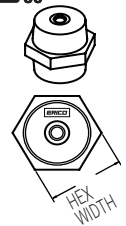

| Description | Part No. | Part Height | Hex Width | Thread Dia | Thread Depth | Face Dia | Voltage AC | Max Working Load (lbs)* | Qty/box | Weight ea. (lbs) |
|---------------------|---------------|-------------|-----------|------------|--------------|----------|------------|-------------------------|---------|------------------|
| ISO 1", 1/4-20* | 559600 | 1 | 1-1/8 | 1/4 | 5/16 | 0.82 | 600 | 1500 | 350 | 0.057 |
| ISO 1", 5/16-18* | 559610 | 1 | 1-1/8 | 5/16 | 5/16 | 0.82 | 600 | 1500 | 350 | 0.059 |
| ISO 1-1/4", 1/4-20 | 559620 | 1-1/4 | 1-5/8 | 1/4 | 5/16 | 1.41 | 750 | 2300 | 675 | 0.118 |
| ISO 1-1/4", 3/8-16 | 559640 | 1-1/4 | 1-5/8 | 3/8 | 3/8 | 1.41 | 750 | 2300 | 675 | 0.141 |
| ISO 1-3/8", 3/8-16 | 559650 | 1-3/8 | 1-3/4 | 3/8 | 3/8 | 1.43 | 750 | 2300 | 1200 | 0.208 |
| ISO 1-1/2", 3/8-16 | 559660 | 1-1/2 | 2 | 3/8 | 3/8 | 1.68 | 1500 | 2300 | 1200 | 0.347 |
| ISO 1-1/2", 1/4-20 | 559662 | 1-1/2 | 2 | 1/4 | 1/2 | 1.68 | 1500 | 2300 | 1200 | 0.273 |
| ISO 1-1/2", 5/16-18 | 559663 | 1-1/2 | 2 | 5/16 | 1/2 | 1.68 | 1500 | 2300 | 1200 | 0.276 |
| ISO 1-3/4", 3/8-16 | 559670 | 1-3/4 | 2 | 3/8 | 9/16 | 1.66 | 2000 | 3000 | 1200 | 0.382 |
| ISO 1-3/4", 5/16-18 | 559671 | 1-3/4 | 2 | 5/16 | 1/2 | 1.66 | 2000 | 3000 | 1200 | 0.311 |
| ISO 2", 1/2-13 | 559681 | 2 | 2 | 1/2 | 5/8 | 1.65 | 2300 | 3000 | 1200 | 0.426 |
| ISO 2", 3/8-16 | 559680 | 2 | 2 | 3/8 | 9/16 | 1.65 | 2300 | 3000 | 1200 | 0.419 |
| ISO 2", 5/16-18 | 559682 | 2 | 2 | 5/16 | 1/2 | 1.65 | 2300 | 3000 | 1200 | 0.354 |
| ISO 2-1/8", 3/8-16 | 559683 | 2-1/8 | 2-1/2 | 3/8 | 5/8 | 2.14 | 2500 | 3000 | 1300 | 0.629 |
| ISO 2-1/8", 1/2-13 | 559684 | 2-1/8 | 2-1/2 | 1/2 | 5/8 | 2.14 | 2500 | 3000 | 1300 | 0.655 |
| ISO 2-1/8", 5/8-11 | 559685 | 2-1/8 | 2-1/2 | 5/8 | 5/8 | 2.14 | 2500 | 3000 | 1300 | 0.745 |
| ISO 2-1/4", 1/2-13 | 559686 | 2-1/4 | 2-1/2 | 1/2 | 5/8 | 2.13 | 2700 | 4000 | 1400 | 0.687 |
| ISO 2-1/4", 3/8-16 | 559687 | 2-1/4 | 2-1/2 | 3/8 | 5/8 | 2.13 | 2700 | 4000 | 1400 | 0.657 |
| ISO 2-1/2", 1/2-13 | 559688 | 2-1/2 | 2-1/2 | 1/2 | 5/8 | 2.11 | 3200 | 4000 | 1400 | 0.743 |
| ISO 2-1/2", 3/8-16 | 559689 | 2-1/2 | 2-1/2 | 3/8 | 5/8 | 2.11 | 3200 | 4000 | 1400 | 0.714 |
| ISO 2-5/8", 5/8-11 | 559690 | 2-5/8 | 2-1/2 | 5/8 | 3/4 | 2.11 | 3400 | 4000 | 1400 | 0.858 |
| ISO 2-3/4", 1/2-13 | 559691 | 2-3/4 | 2-1/2 | 1/2 | 5/8 | 2.10 | 3600 | 4000 | 1400 | 0.799 |
| ISO 2-3/4", 3/8-16 | 559692 | 2-3/4 | 2-1/2 | 3/8 | 5/8 | 2.10 | 3600 | 4000 | 1400 | 0.770 |
| ISO 3", 1/2-13 | 559693 | 3 | 2-1/2 | 1/2 | 5/8 | 2.08 | 4100 | 4000 | 1400 | 0.853 |
| ISO 3", 3/8-16 | 559694 | 3 | 2-1/2 | 3/8 | 5/8 | 2.08 | 4100 | 4000 | 1400 | 0.824 |
| ISO 3-1/4", 1/2-13 | 559695 | 3-1/4 | 2-1/2 | 1/2 | 5/8 | 2.06 | 4500 | 4000 | 1400 | 0.907 |
| ISO 3-1/4", 3/8-16 | 559696 | 3-1/4 | 2-1/2 | 3/8 | 5/8 | 2.06 | 4500 | 4000 | 1400 | 0.878 |
| ISO 3-1/2", 5/8-11 | 559697 | 3-1/2 | 2-1/2 | 5/8 | 3/4 | 2.05 | 5000 | 5000 | 1400 | 1.047 |
| ISO 3-1/2", 3/8-16 | 559698 | 3-1/2 | 2-1/2 | 3/8 | 3/4 | 2.05 | 5000 | 5000 | 1400 | 0.950 |

* Not recognized for strength

ISOBOLT INSULATOR MOUNTING KITS

- Complete with stud, washer, lock washer, nut
- ISO M sizes
- Zinc plated steel



| Part No. | Description | Thread | Length mm |  |  |
|---------------|---------------|--------|-----------|---|---|
| 552200 | ISOBOLT 25 M6 | M6 | 25 | 20 | 0,008 |
| 552220 | ISOBOLT 30 M8 | M8 | 30 | 20 | 0,017 |

Insulators



nVent offers a full range of nVent ERIFLEX low-voltage stand-off insulators from 1 inch to 3.5 inches with a total of 29 sizes available. The cost-effective insulators offer great stability of electrical and mechanical parameters and very high resistance to leakage current.

The insulators are manufactured from a halogen-free fiberglass-reinforced thermalset unsaturated polyester molded compound (BMC). Their electro-plated zinc inserts are threaded to ASME® standards. The insulators work in temperatures from -40°F to 266°F.

- Wide range of sizes from 1 inch to 3.5 inches
- Cost effective
- cULus recognized for strength and material
- Working range of -40°F to 266°F
- High resistance to leakage current

The stand-off insulators meet the requirements of UL® 94 VO for self-extinguishing materials and are UL Recognized to Standard 891, Supplement B, Dead-front Switchboards and Accessories, 600 volt, File No. E125470. The insulators are also UL recognized for Canada for material and strength. nVent ERIFLEX insulators are the first on the market to be in compliance with the CSA® standard.

cUL[®] US

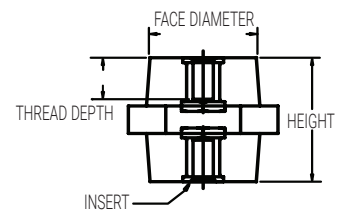
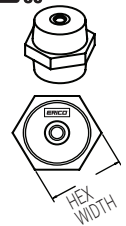

| Description | Part No. | Part Height | Hex Width | Thread Dia | Thread Depth | Face Dia | Voltage AC | Max Working Load (lbs)* | Qty/box | Weight ea. (lbs) |
|---------------------|---------------|-------------|-----------|------------|--------------|----------|------------|-------------------------|---------|------------------|
| ISO 1", 1/4-20* | 559600 | 1 | 1-1/8 | 1/4 | 5/16 | 0.82 | 600 | 1500 | 50 | 0.057 |
| ISO 1", 5/16-18* | 559610 | 1 | 1-1/8 | 5/16 | 5/16 | 0.82 | 600 | 1500 | 50 | 0.059 |
| ISO 1-1/4", 1/4-20 | 559620 | 1-1/4 | 1-5/8 | 1/4 | 5/16 | 1.41 | 750 | 2300 | 25 | 0.118 |
| ISO 1-1/4", 3/8-16 | 559640 | 1-1/4 | 1-5/8 | 3/8 | 3/8 | 1.41 | 750 | 2300 | 25 | 0.141 |
| ISO 1-3/8", 3/8-16 | 559650 | 1-3/8 | 1-3/4 | 3/8 | 3/8 | 1.43 | 750 | 2300 | 25 | 0.208 |
| ISO 1-1/2", 3/8-16 | 559660 | 1-1/2 | 2 | 3/8 | 3/8 | 1.68 | 1500 | 2300 | 25 | 0.347 |
| ISO 1-1/2", 1/4-20 | 559662 | 1-1/2 | 2 | 1/4 | 1/2 | 1.68 | 1500 | 2300 | 25 | 0.273 |
| ISO 1-1/2", 5/16-18 | 559663 | 1-1/2 | 2 | 5/16 | 1/2 | 1.68 | 1500 | 2300 | 25 | 0.276 |
| ISO 1-3/4", 3/8-16 | 559670 | 1-3/4 | 2 | 3/8 | 9/16 | 1.66 | 2000 | 3000 | 25 | 0.382 |
| ISO 1-3/4", 5/16-18 | 559671 | 1-3/4 | 2 | 5/16 | 1/2 | 1.66 | 2000 | 3000 | 25 | 0.311 |
| ISO 2", 1/2-13 | 559681 | 2 | 2 | 1/2 | 5/8 | 1.65 | 2300 | 3000 | 25 | 0.426 |
| ISO 2", 3/8-16 | 559680 | 2 | 2 | 3/8 | 9/16 | 1.65 | 2300 | 3000 | 25 | 0.419 |
| ISO 2", 5/16-18 | 559682 | 2 | 2 | 5/16 | 1/2 | 1.65 | 2300 | 3000 | 25 | 0.354 |
| ISO 2-1/8", 3/8-16 | 559683 | 2-1/8 | 2-1/2 | 3/8 | 5/8 | 2.14 | 2500 | 3000 | 25 | 0.629 |
| ISO 2-1/8", 1/2-13 | 559684 | 2-1/8 | 2-1/2 | 1/2 | 5/8 | 2.14 | 2500 | 3000 | 25 | 0.655 |
| ISO 2-1/8", 5/8-11 | 559685 | 2-1/8 | 2-1/2 | 5/8 | 5/8 | 2.14 | 2500 | 3000 | 25 | 0.745 |
| ISO 2-1/4", 1/2-13 | 559686 | 2-1/4 | 2-1/2 | 1/2 | 5/8 | 2.13 | 2700 | 4000 | 25 | 0.687 |
| ISO 2-1/4", 3/8-16 | 559687 | 2-1/4 | 2-1/2 | 3/8 | 5/8 | 2.13 | 2700 | 4000 | 25 | 0.657 |
| ISO 2-1/2", 1/2-13 | 559688 | 2-1/2 | 2-1/2 | 1/2 | 5/8 | 2.11 | 3200 | 4000 | 10 | 0.743 |
| ISO 2-1/2", 3/8-16 | 559689 | 2-1/2 | 2-1/2 | 3/8 | 5/8 | 2.11 | 3200 | 4000 | 10 | 0.714 |
| ISO 2-5/8", 5/8-11 | 559690 | 2-5/8 | 2-1/2 | 5/8 | 3/4 | 2.11 | 3400 | 4000 | 10 | 0.858 |
| ISO 2-3/4", 1/2-13 | 559691 | 2-3/4 | 2-1/2 | 1/2 | 5/8 | 2.10 | 3600 | 4000 | 10 | 0.799 |
| ISO 2-3/4", 3/8-16 | 559692 | 2-3/4 | 2-1/2 | 3/8 | 5/8 | 2.10 | 3600 | 4000 | 10 | 0.770 |
| ISO 3", 1/2-13 | 559693 | 3 | 2-1/2 | 1/2 | 5/8 | 2.08 | 4100 | 4000 | 10 | 0.853 |
| ISO 3", 3/8-16 | 559694 | 3 | 2-1/2 | 3/8 | 5/8 | 2.08 | 4100 | 4000 | 10 | 0.824 |
| ISO 3-1/4", 1/2-13 | 559695 | 3-1/4 | 2-1/2 | 1/2 | 5/8 | 2.06 | 4500 | 4000 | 10 | 0.907 |
| ISO 3-1/4", 3/8-16 | 559696 | 3-1/4 | 2-1/2 | 3/8 | 5/8 | 2.06 | 4500 | 4000 | 10 | 0.878 |
| ISO 3-1/2", 5/8-11 | 559697 | 3-1/2 | 2-1/2 | 5/8 | 3/4 | 2.05 | 5000 | 5000 | 10 | 1.047 |
| ISO 3-1/2", 3/8-16 | 559698 | 3-1/2 | 2-1/2 | 3/8 | 3/4 | 2.05 | 5000 | 5000 | 10 | 0.950 |

* Not recognized for strength

ISOBOLT INSULATOR MOUNTING KITS

- Complete with stud, washer, lock washer, nut
- ISO M sizes
- Zinc plated steel



| Part No. | Description | Thread | Length mm |  |  |
|---------------|---------------|--------|-----------|---|---|
| 552200 | ISOBOLT 25 M6 | M6 | 25 | 20 | 0,008 |
| 552220 | ISOBOLT 30 M8 | M8 | 30 | 20 | 0,017 |