

B36PLRIC-E

6" Compact Fluorescent Slope IC Remodel Housing

LAMP WATTAGE: UP TO 26W

Catalog Number:

Project Name:

Type:

Note:



2/12 TO 6/12 PITCH (9° TO 27°)

DESCRIPTION

Thermally protected, IC rated specification grade remodel compact fluorescent recessed housing. For remodeling installations where housing will be in direct contact with insulation. Designed for sloped ceiling applications where the ceiling pitch ranges from 2/12 to 6/12. Accommodates (1) 13W, 18W or 26W compact fluorescent lamp. For fast and easy installation in existing plaster or mechanical ceilings from 1/2" to 1-3/8" thick. Four remodel clips are easily retractable for fixture removal if necessary. Junction box is provided with eight 1/2" KO's and four Romex knockouts with strain relief.

SPECIFICATION

A. HOUSING - Die-formed, all aluminum construction for maximum heat dissipation and rust protection.

B. SOCKET - One vertically mounted plug-in socket. Unitized optics guarantees proper trim to housing installation. Tool-less installation adjusts from inside the housing.

C. INSTALLATION - Four preinstalled spring clips which secure the housing firmly into ceiling to accommodate different ceiling thicknesses from 1/2" to 1-3/8".

D. JUNCTION BOX - Provided with eight 1/2" KO's and four Romex knockouts with strain relief.

E. BALLAST - Thermally protected, current controlled ballast, will produce full light output, increase lamp life with no noise and flicker. Ballast supplied is manufactured by Advance.

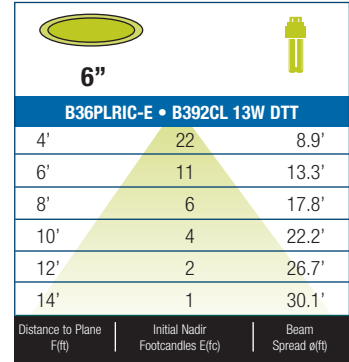

BEAM DIA. MEASURED AT 50% OF NADIR F.C.

FEATURES

- Thermally Protected remodel compact fluorescent IC housing.
- Integral fluorescent ballast.
- Unit slips through 6-1/2" ceiling opening.
- Four Preinstalled spring clips which secure the housing firmly into ceiling to accommodate ceiling thickness from 1/2" to 1-3/8".
- Can be installed from below the ceiling.
- Adjustable socket bracket with a slope indicator provides consistent lamp alignment and setup.
- Wire through junction box.
- Dependable, favorable design and effortless installation.
- 7-1/4" height allows use in 2" x 8" joist construction.

OPTIONS

AIR-SHUT

- Gasket to prevent air flow from heated or air conditioned spaces.
- Meets all national air flow requirements.

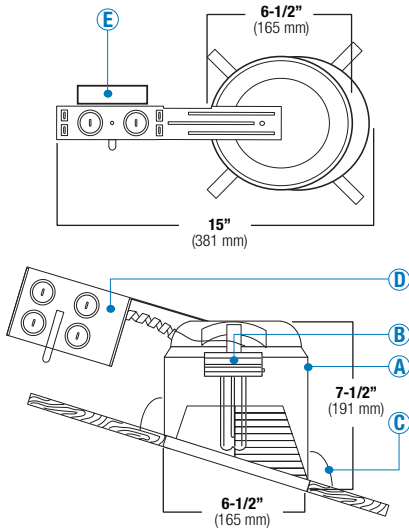

B36PLRIC-E - ITEM SELECTOR: (Please check the boxes below for the option desired)

WATTAGE	BALLAST	VOLTAGE	EMERGENCY OPTIONS	TRIM TYPE	BAFFLE	REFLECTOR	TRIM/RING
<input type="checkbox"/> 13W	<input type="checkbox"/> (E) Electronic	<input type="checkbox"/> 120	<input type="checkbox"/> EMG 750 (750 Lumens) ⁶	<input type="checkbox"/> B391	<input type="checkbox"/> W	<input type="checkbox"/> CL	<input type="checkbox"/> WH
<input type="checkbox"/> 18W	<input type="checkbox"/> (E-AD) Electronic ¹	<input type="checkbox"/> 277	<input type="checkbox"/> EMG 1300 (1300 Lumens) ⁶	<input type="checkbox"/> B397	<input type="checkbox"/> P	<input type="checkbox"/> RG	<input type="checkbox"/> BK
<input type="checkbox"/> 26W	<input type="checkbox"/> (S) Energy Star ²		<input type="checkbox"/> EMG-D-750 (750 Lumens) ⁷	<input type="checkbox"/> B601	<input type="checkbox"/> SN	<input type="checkbox"/> W	<input type="checkbox"/> SN
			<input type="checkbox"/> ICE-1300 (1300 Lumens) ⁸	<input type="checkbox"/> B601L	<input type="checkbox"/> CP	<input type="checkbox"/> MB	<input type="checkbox"/> CP
				<input type="checkbox"/> B605	<input type="checkbox"/> BZ	<input type="checkbox"/> BZ	<input type="checkbox"/> CH
				<input type="checkbox"/> B605L		<input type="checkbox"/> CP	<input type="checkbox"/> PB
						<input type="checkbox"/> SN	<input type="checkbox"/> BZ
						<input type="checkbox"/> SHZ	
	DIMMING	AIR-SHUT	OTHER OPTIONS				
	<input type="checkbox"/> Mark 7 ³	<input type="checkbox"/> AT	<input type="checkbox"/> FUSE ⁹				
	<input type="checkbox"/> Mark 10 ⁴		<input type="checkbox"/> RIF ¹⁰				
	<input type="checkbox"/> Lut-E (EC3D) ⁵						
	<input type="checkbox"/> REB-DIM-120						

(Note: CA Title 24 approved only if ordered with electronic ballast and Air-Shut.) 1 - (E-AD) Advance Electronic Ballast • 2 - (S) Energy Star = Available on selected fixtures only, please see list above • 3 - MARK 7 = Not available in 9W, 13W, 57W, 70W • 4 - MARK 10 = Not available in 9W, 13W, 57W, 70W, must specify voltage • 5 - LUT-E (EC3D) = Not available in 9W, 13W, 57W, 70W • 6 - EMG = Emergency battery pack w/ remote test switch • 7 - EMG-D = Emergency battery pack w/ remote test switch for damp location • 8 - ICE = Emergency battery pack w/ remote test switch operating between -18°C and 55°C • 9 - FUSE = Single slow-blow fuse • 10 - RIF = Radio interference filter

Specifications:

B36PLRIC-E _____
 WATT BALLAST VOLTAGE AIR-SHUT EMERGENCY OPTIONS TRIM TYPE REFLECTOR BAFFLE RING

BAFFLE	REFLECTOR	TRIM/RING
W White	CL Chrome	WH White
P Black	RG Gold	BK Black
SN Satin Nickel	W White	SN Satin Nickel
CP Copper	MB Black	CP Copper
BZ Bronze	BZ Bronze	CH Chrome
	CP Copper	PB Polish Brass
	SN Satin Nickel	BZ Bronze
	SHZ Satin Haze	

Sample of Catalog Number: B36PLRIC-26W-E-MVOLT-EMG750-B391W-WH

*For custom baffle, reflector, trim ring, glass color and lens options, please consult factory.



Submission form is available @ www.iuseelite.com
 Tel: 323-888-1973 • Fax: 323-888-1977

Specifications and Dimensions subject to change without notice.

REV: ELITE LIGHTING-SPEC-06-29-2011

6" Slope Ceiling CFL Trims

(LAMP WATTAGE: UP TO 26W)

Catalog Number:

Project Name:

Type:

Note:



B391CP-CP STEPPED BAFFLE



BAFFLE FINISH:
W, P, SN, CP, BZ

TRIM/RING FINISH:
WH, BK, SN, CP, CH,
PB, BZ

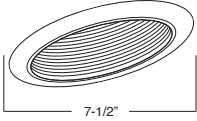

B397RG-WH REFLECTOR



REFLECTOR FINISH:
CL, RG, W, MB, CP, SN,
BZ, SHZ

TRIM/RING FINISH:
WH, BK, SN, CP, CH,
PB, BZ

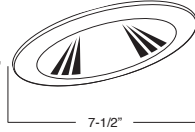

B601CP METAL ALBALITE LENS



FOR
WET
LOCATION

LENS:
ALBALITE

TRIM/RING FINISH:
WH, BK, SN, CP, CH,
PB, BZ

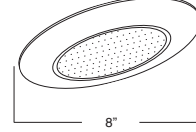

B601L PLASTIC ALBALITE LENS



FOR
WET
LOCATION

LENS:
ALBALITE

TRIM/RING FINISH:
WHITE PLASTIC

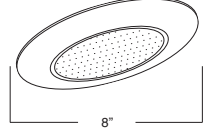

B605PB METAL FRESNEL LENS

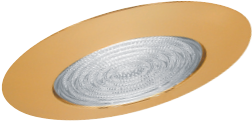

FOR
WET
LOCATION

LENS:
FRESNEL

TRIM/RING FINISH:
WH, BK, SN, CP, CH,
PB, BZ

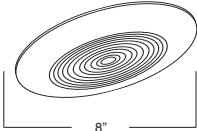

B605L PLASTIC FRESNEL LENS



FOR
WET
LOCATION

LENS:
FRESNEL

TRIM/RING FINISH:
WHITE PLASTIC

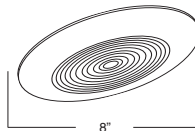

BAFFLE		REFLECTOR		TRIM RING	
W	White	CL	Chrome	WH	White
P	Black	RG	Gold	BK	Black
SN	Satin Nickel	W	White	SN	Satin Nickel
CP	Copper	MB	Black	CP	Copper
BZ	Bronze	CP	Copper	CH	Chrome
		SN	Satin Nickel	PB	Polish Brass
				BZ	Bronze

*For custom baffle, reflector, trim ring, glass color and lens options, please consult factory.

B36PLRIC-E

6" Compact Fluorescent Slope IC Remodel Housing

LAMP WATTAGE: UP TO 26W

Catalog Number:

Project Name:

Type:

Note:



2/12 TO 6/12 PITCH (9° TO 27°)

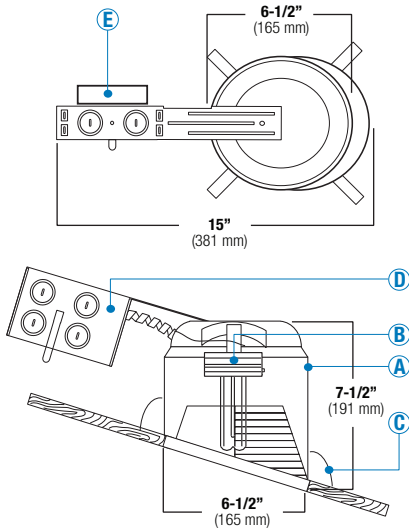

DESCRIPTION

Thermally protected, IC rated specification grade remodel compact fluorescent recessed housing. For remodeling installations where housing will be in direct contact with insulation. Designed for sloped ceiling applications where the ceiling pitch ranges from 2/12 to 6/12. Accommodates (1) 13W, 18W or 26W compact fluorescent lamp. For fast and easy installation in existing plaster or mechanical ceilings from 1/2" to 1-3/8" thick. Four remodel clips are easily retractable for fixture removal if necessary. Junction box is provided with eight 1/2" KO's and four Romex knockouts with strain relief.

SPECIFICATION

A. HOUSING - Die-formed, all aluminum construction for maximum heat dissipation and rust protection.

B. SOCKET - One vertically mounted plug-in socket. Unitized optics guarantees proper trim to housing installation. Tool-less installation adjusts from inside the housing.

C. INSTALLATION - Four preinstalled spring clips which secure the housing firmly into ceiling to accommodate different ceiling thicknesses from 1/2" to 1-3/8".

D. JUNCTION BOX - Provided with eight 1/2" KO's and four Romex knockouts with strain relief.

E. BALLAST - Thermally protected, current controlled ballast, will produce full light output, increase lamp life with no noise and flicker. Ballast supplied is manufactured by Advance.

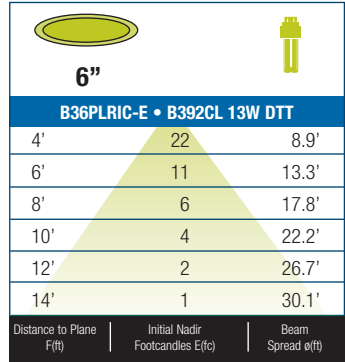

BEAM DIA. MEASURED AT 50% OF NADIR F.C.

FEATURES

- Thermally Protected remodel compact fluorescent IC housing.
- Integral fluorescent ballast.
- Unit slips through 6-1/2" ceiling opening.
- Four Preinstalled spring clips which secure the housing firmly into ceiling to accommodate ceiling thickness from 1/2" to 1-3/8".
- Can be installed from below the ceiling.
- Adjustable socket bracket with a slope indicator provides consistent lamp alignment and setup.
- Wire through junction box.
- Dependable, favorable design and effortless installation.
- 7-1/4" height allows use in 2" x 8" joist construction.

OPTIONS

AIR-SHUT

- Gasket to prevent air flow from heated or air conditioned spaces.
- Meets all national air flow requirements.



B36PLRIC-E - ITEM SELECTOR: (Please check the boxes below for the option desired)

WATTAGE	BALLAST	VOLTAGE	EMERGENCY OPTIONS	TRIM TYPE	BAFFLE	REFLECTOR	TRIM/RING
<input type="checkbox"/> 13W	<input type="checkbox"/> (E) Electronic	<input type="checkbox"/> 120	<input type="checkbox"/> EMG 750 (750 Lumens) ⁶	<input type="checkbox"/> B391	<input type="checkbox"/> W	<input type="checkbox"/> CL	<input type="checkbox"/> WH
<input type="checkbox"/> 18W	<input type="checkbox"/> (E-AD) Electronic ¹	<input type="checkbox"/> 277	<input type="checkbox"/> EMG 1300 (1300 Lumens) ⁶	<input type="checkbox"/> B397	<input type="checkbox"/> P	<input type="checkbox"/> RG	<input type="checkbox"/> BK
<input type="checkbox"/> 26W	<input type="checkbox"/> (S) Energy Star ²		<input type="checkbox"/> EMG-D-750 (750 Lumens) ⁷	<input type="checkbox"/> B601	<input type="checkbox"/> SN	<input type="checkbox"/> W	<input type="checkbox"/> SN
			<input type="checkbox"/> ICE-1300 (1300 Lumens) ⁸	<input type="checkbox"/> B601L	<input type="checkbox"/> CP	<input type="checkbox"/> MB	<input type="checkbox"/> CP
				<input type="checkbox"/> B605	<input type="checkbox"/> BZ	<input type="checkbox"/> BZ	<input type="checkbox"/> CH
				<input type="checkbox"/> B605L		<input type="checkbox"/> CP	<input type="checkbox"/> PB
						<input type="checkbox"/> SN	<input type="checkbox"/> BZ
						<input type="checkbox"/> SHZ	
	DIMMING	AIR-SHUT	OTHER OPTIONS				
	<input type="checkbox"/> Mark 7 ³	<input type="checkbox"/> AT	<input type="checkbox"/> FUSE ⁹				
	<input type="checkbox"/> Mark 10 ⁴		<input type="checkbox"/> RIF ¹⁰				
	<input type="checkbox"/> Lut-E (EC3D) ⁵						
	<input type="checkbox"/> REB-DIM-120						

(Note: CA Title 24 approved only if ordered with electronic ballast and Air-Shut.) 1 - (E-AD) Advance Electronic Ballast • 2 - (S) Energy Star = Available on selected fixtures only, please see list above • 3 - MARK 7 = Not available in 9W, 13W, 57W, 70W • 4 - MARK 10 = Not available in 9W, 13W, 57W, 70W, must specify voltage • 5 - LUT-E (EC3D) = Not available in 9W, 13W, 57W, 70W • 6 - EMG = Emergency battery pack w/ remote test switch • 7 - EMG-D = Emergency battery pack w/ remote test switch for damp location • 8 - ICE = Emergency battery pack w/ remote test switch operating between -18°C and 55°C • 9 - FUSE = Single slow-blow fuse • 10 - RIF = Radio interference filter

Specifications:

B36PLRIC-E _____ - WATT _____ - BALLAST _____ - VOLTAGE _____ - AIR-SHUT _____ - EMERGENCY _____ - OPTIONS _____ - TRIM TYPE _____ - REFLECTOR _____ - BAFFLE _____ - RING _____

BAFFLE	REFLECTOR	TRIM/RING
W White	CL Chrome	WH White
P Black	RG Gold	BK Black
SN Satin Nickel	W White	SN Satin Nickel
CP Copper	MB Black	CP Copper
BZ Bronze	CP Copper	CH Chrome
	BZ Bronze	PB Polish Brass
	SN Satin Nickel	BZ Bronze
	SHZ Satin Haze	

Sample of Catalog Number: **B36PLRIC-26W-E-MVOLT-EMG750-B391W-WH**

*For custom baffle, reflector, trim ring, glass color and lens options, please consult factory.



Submission form is available @ www.iuseelite.com
Tel: 323-888-1973 • Fax: 323-888-1977

Specifications and Dimensions subject to change without notice.

REV: ELITE LIGHTING-SPEC-06-29-2011

6" Slope Ceiling CFL Trims

(LAMP WATTAGE: UP TO 26W)

Catalog Number:

Project Name:

Type:

Note:



**B391CP-CP
STEPPED BAFFLE**



BAFFLE FINISH:
W, P, SN, CP, BZ

TRIM/RING FINISH:
WH, BK, SN, CP, CH,
PB, BZ

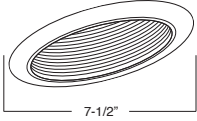

**B397RG-WH
REFLECTOR**



REFLECTOR FINISH:
CL, RG, W, MB, CP, SN,
BZ, SHZ

TRIM/RING FINISH:
WH, BK, SN, CP, CH,
PB, BZ

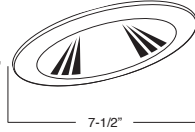

**B601CP
METAL ALBALITE LENS**



FOR
WET
LOCATION

LENS:
ALBALITE

TRIM/RING FINISH:
WH, BK, SN, CP, CH,
PB, BZ

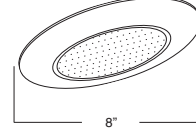

**B601L
PLASTIC ALBALITE LENS**



FOR
WET
LOCATION

LENS:
ALBALITE

TRIM/RING FINISH:
WHITE PLASTIC

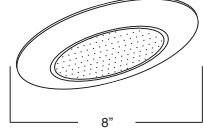

**B605PB
METAL FRESNEL LENS**

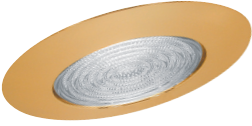

FOR
WET
LOCATION

LENS:
FRESNEL

TRIM/RING FINISH:
WH, BK, SN, CP, CH,
PB, BZ

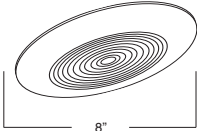

**B605L
PLASTIC FRESNEL LENS**



FOR
WET
LOCATION

LENS:
FRESNEL

TRIM/RING FINISH:
WHITE PLASTIC

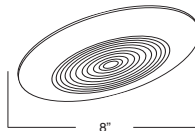

BAFFLE		REFLECTOR		TRIM RING	
W	White	CL	Chrome	WH	White
P	Black	RG	Gold	BK	Black
SN	Satin Nickel	W	White	SN	Satin Nickel
CP	Copper	MB	Black	CP	Copper
BZ	Bronze	CP	Copper	CH	Chrome
		SN	Satin Nickel	PB	Polish Brass
				BZ	Bronze

*For custom baffle, reflector, trim ring, glass color and lens options, please consult factory.