

# CONNECTORS

## Compression Connectors

### Long Barrel One Hole Copper Lugs L Series



#### FEATURES

- Produced from high conductivity copper tubing.
- Tin-plated to provide corrosion low contact resistance.
- Marked with die index and color coded.
- Listed for 35KV max when properly installed and to cable manufacturer instructions.
- For applications greater than 2000V, consult the cable Manufacturer voltage stress relief instructions.
- **Part Numbers ending in "P" have a "peep" or sight inspection hole.**

#### SPECIFICATIONS

- UL486A Listed Wire Connector.
- UL467 Grounding & Bonding (Sizes 8 AWG - 3/0 AWG).
- Max ampacity is based on NEC 310.15, insulation type, and conductor material. Please consult your current NEC manual.
- \* CLASS B OR C BUILDING WIRE CU CABLE ONLY.
- Temperature Rating: 90 °C.
- Voltage: 600V

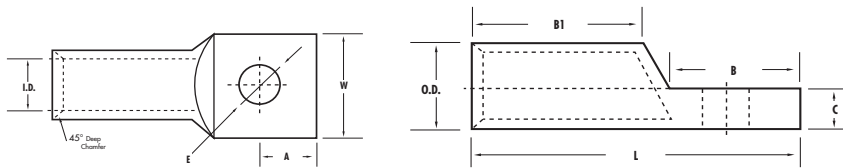

**\*EXPANDED WIRE RANGE** when installed with NSI N121D dieless compression tool.  
UL Listed with other tools:  
**FOR TOOL/DIE CRIMPING INFORMATION, PLEASE SEE TABLE ON PAGE 87**

| CAT. NO. | WIRE RANGE | EXPANDED WIRE RANGE** | BOLT SIZE (IN.) | BARREL I.D. | BARREL O.D. | LENGTH (L) (IN.) | WIDTH (W) (IN.) | A (IN.) | B (IN.) | B1 (IN.) | C (IN.) | E (IN.) | COLOR | STD. CTN. QTY. |
|----------|------------|-----------------------|-----------------|-------------|-------------|------------------|-----------------|---------|---------|----------|---------|---------|-------|----------------|
| L810     | 8 AWG      | 8 - 10 AWG            | #10             | 0.205       | 0.295       | 1.520            | 0.420           | 0.280   | 0.590   | 0.810    | 0.080   | 0.210   | Red   | 100            |
| L810P    | 8 AWG      | 8 - 10 AWG            | #10             | 0.205       | 0.295       | 1.520            | 0.420           | 0.280   | 0.590   | 0.810    | 0.080   | 0.210   | Red   | 100            |
| L814     | 8 AWG      | 8 - 10 AWG            | 1/4"            | 0.205       | 0.295       | 1.520            | 0.420           | 0.280   | 0.590   | 0.810    | 0.080   | 0.252   | Red   | 100            |
| L814P    | 8 AWG      | 8 - 10 AWG            | 1/4"            | 0.205       | 0.295       | 1.520            | 0.420           | 0.280   | 0.590   | 0.810    | 0.080   | 0.252   | Red   | 100            |
| L838     | 8 AWG      | 8 - 10 AWG            | 3/8"            | 0.205       | 0.295       | 1.520            | 0.420           | 0.280   | 0.590   | 0.810    | 0.080   | 0.413   | Red   | 100            |
| L838P    | 8 AWG      | 8 - 10 AWG            | 3/8"            | 0.205       | 0.295       | 1.520            | 0.420           | 0.280   | 0.590   | 0.810    | 0.080   | 0.413   | Red   | 100            |
| L610     | 6 AWG      | 6 - 8 AWG             | #10             | 0.205       | 0.295       | 1.770            | 0.420           | 0.300   | 0.640   | 0.980    | 0.083   | 0.210   | Blue  | 100            |
| L614     | 6 AWG      | 6 - 8 AWG             | 1/4"            | 0.205       | 0.295       | 1.772            | 0.421           | 0.295   | 0.669   | 0.984    | 0.083   | 0.252   | Blue  | 100            |
| L614P    | 6 AWG      | 6 - 8 AWG             | 1/4"            | 0.205       | 0.295       | 1.772            | 0.421           | 0.295   | 0.669   | 0.984    | 0.083   | 0.252   | Blue  | 100            |
| L638     | 6 AWG      | 6 - 8 AWG             | 3/8"            | 0.205       | 0.295       | 1.913            | 0.591           | 0.370   | 0.811   | 0.984    | 0.083   | 0.413   | Blue  | 100            |
| L638P    | 6 AWG      | 6 - 8 AWG             | 3/8"            | 0.205       | 0.295       | 1.913            | 0.591           | 0.370   | 0.811   | 0.984    | 0.083   | 0.413   | Blue  | 100            |
| L656     | 6 AWG      | 6 - 8 AWG             | 5/16"           | 0.205       | 0.295       | 1.910            | 0.590           | 0.370   | 0.810   | 0.980    | 0.083   | 0.330   | Blue  | 100            |
| L656P    | 6 AWG      | 6 - 8 AWG             | 5/16"           | 0.205       | 0.295       | 1.910            | 0.590           | 0.370   | 0.810   | 0.980    | 0.083   | 0.330   | Blue  | 100            |
| L410     | 4 AWG      | 4 - 6 AWG             | #10             | 0.252       | 0.343       | 1.770            | 0.488           | 0.315   | 0.669   | 0.980    | 0.087   | 0.210   | Gray  | 100            |
| L414     | 4 AWG      | 4 - 6 AWG             | 1/4"            | 0.252       | 0.343       | 1.772            | 0.488           | 0.315   | 0.669   | 0.984    | 0.087   | 0.252   | Gray  | 100            |
| L414P    | 4 AWG      | 4 - 6 AWG             | 1/4"            | 0.252       | 0.343       | 1.772            | 0.488           | 0.315   | 0.669   | 0.984    | 0.087   | 0.252   | Gray  | 100            |
| L438     | 4 AWG      | 4 - 6 AWG             | 3/8"            | 0.252       | 0.343       | 1.913            | 0.591           | 0.370   | 0.811   | 0.984    | 0.087   | 0.413   | Gray  | 100            |
| L438P    | 4 AWG      | 4 - 6 AWG             | 3/8"            | 0.252       | 0.343       | 1.913            | 0.591           | 0.370   | 0.811   | 0.984    | 0.087   | 0.413   | Gray  | 100            |
| L456     | 4 AWG      | 4 - 6 AWG             | 5/16"           | 0.252       | 0.343       | 1.772            | 0.488           | 0.315   | 0.669   | 0.984    | 0.087   | 0.331   | Gray  | 100            |
| L456P    | 4 AWG      | 4 - 6 AWG             | 5/16"           | 0.252       | 0.343       | 1.772            | 0.488           | 0.315   | 0.669   | 0.984    | 0.087   | 0.331   | Gray  | 100            |
| L314     | 3 AWG      | 3 - 6 AWG             | 1/4"            | 0.270       | 0.377       | 2.344            | 0.531           | 0.323   | 0.828   | 1.169    | 0.097   | 0.277   | White | 100            |
| L356     | 3 AWG      | 3 - 6 AWG             | 5/16"           | 0.270       | 0.377       | 2.157            | 0.538           | 0.346   | 0.767   | 1.120    | 0.091   | 0.336   | White | 50             |

# CONNECTORS

## Compression Connectors

### Long Barrel One Hole Copper Lugs L Series



#### FEATURES

- Produced from high conductivity copper tubing.
- Tin-plated to provide corrosion low contact resistance.
- Marked with die index and color coded.
- Listed for 35KV max when properly installed and to cable manufacturer instructions.
- For applications greater than 2000V, consult the cable Manufacturer voltage stress relief instructions.
- **Part Numbers ending in "P" have a "peep" or sight inspection hole.**

#### SPECIFICATIONS

- UL486A Listed Wire Connector.
- UL467 Grounding & Bonding (Sizes 8 AWG - 3/0 AWG).
- Max ampacity is based on NEC 310.15, insulation type, and conductor material. Please consult your current NEC manual.
- \* CLASS B OR C BUILDING WIRE CU CABLE ONLY.
- Temperature Rating: 90 °C.
- Voltage: 600V

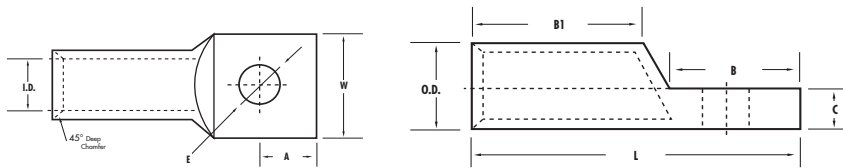

**\*EXPANDED WIRE RANGE** when installed with NSI N121D dieless compression tool.  
UL Listed with other tools:  
**FOR TOOL/DIE CRIMPING INFORMATION, PLEASE SEE TABLE ON PAGE 87**

| CAT. NO. | WIRE RANGE | EXPANDED WIRE RANGE** | BOLT SIZE (IN.) | BARREL I.D. | BARREL O.D. | LENGTH (L) (IN.) | WIDTH (W) (IN.) | A (IN.) | B (IN.) | B1 (IN.) | C (IN.) | E (IN.) | COLOR | STD. CTN. QTY. |
|----------|------------|-----------------------|-----------------|-------------|-------------|------------------|-----------------|---------|---------|----------|---------|---------|-------|----------------|
| L810     | 8 AWG      | 8 - 10 AWG            | #10             | 0.205       | 0.295       | 1.520            | 0.420           | 0.280   | 0.590   | 0.810    | 0.080   | 0.210   | Red   | 100            |
| L810P    | 8 AWG      | 8 - 10 AWG            | #10             | 0.205       | 0.295       | 1.520            | 0.420           | 0.280   | 0.590   | 0.810    | 0.080   | 0.210   | Red   | 100            |
| L814     | 8 AWG      | 8 - 10 AWG            | 1/4"            | 0.205       | 0.295       | 1.520            | 0.420           | 0.280   | 0.590   | 0.810    | 0.080   | 0.252   | Red   | 100            |
| L814P    | 8 AWG      | 8 - 10 AWG            | 1/4"            | 0.205       | 0.295       | 1.520            | 0.420           | 0.280   | 0.590   | 0.810    | 0.080   | 0.252   | Red   | 100            |
| L838     | 8 AWG      | 8 - 10 AWG            | 3/8"            | 0.205       | 0.295       | 1.520            | 0.420           | 0.280   | 0.590   | 0.810    | 0.080   | 0.413   | Red   | 100            |
| L838P    | 8 AWG      | 8 - 10 AWG            | 3/8"            | 0.205       | 0.295       | 1.520            | 0.420           | 0.280   | 0.590   | 0.810    | 0.080   | 0.413   | Red   | 100            |
| L610     | 6 AWG      | 6 - 8 AWG             | #10             | 0.205       | 0.295       | 1.770            | 0.420           | 0.300   | 0.640   | 0.980    | 0.083   | 0.210   | Blue  | 100            |
| L614     | 6 AWG      | 6 - 8 AWG             | 1/4"            | 0.205       | 0.295       | 1.772            | 0.421           | 0.295   | 0.669   | 0.984    | 0.083   | 0.252   | Blue  | 100            |
| L614P    | 6 AWG      | 6 - 8 AWG             | 1/4"            | 0.205       | 0.295       | 1.772            | 0.421           | 0.295   | 0.669   | 0.984    | 0.083   | 0.252   | Blue  | 100            |
| L638     | 6 AWG      | 6 - 8 AWG             | 3/8"            | 0.205       | 0.295       | 1.913            | 0.591           | 0.370   | 0.811   | 0.984    | 0.083   | 0.413   | Blue  | 100            |
| L638P    | 6 AWG      | 6 - 8 AWG             | 3/8"            | 0.205       | 0.295       | 1.913            | 0.591           | 0.370   | 0.811   | 0.984    | 0.083   | 0.413   | Blue  | 100            |
| L656     | 6 AWG      | 6 - 8 AWG             | 5/16"           | 0.205       | 0.295       | 1.910            | 0.590           | 0.370   | 0.810   | 0.980    | 0.083   | 0.330   | Blue  | 100            |
| L656P    | 6 AWG      | 6 - 8 AWG             | 5/16"           | 0.205       | 0.295       | 1.910            | 0.590           | 0.370   | 0.810   | 0.980    | 0.083   | 0.330   | Blue  | 100            |
| L410     | 4 AWG      | 4 - 6 AWG             | #10             | 0.252       | 0.343       | 1.770            | 0.488           | 0.315   | 0.669   | 0.980    | 0.087   | 0.210   | Gray  | 100            |
| L414     | 4 AWG      | 4 - 6 AWG             | 1/4"            | 0.252       | 0.343       | 1.772            | 0.488           | 0.315   | 0.669   | 0.984    | 0.087   | 0.252   | Gray  | 100            |
| L414P    | 4 AWG      | 4 - 6 AWG             | 1/4"            | 0.252       | 0.343       | 1.772            | 0.488           | 0.315   | 0.669   | 0.984    | 0.087   | 0.252   | Gray  | 100            |
| L438     | 4 AWG      | 4 - 6 AWG             | 3/8"            | 0.252       | 0.343       | 1.913            | 0.591           | 0.370   | 0.811   | 0.984    | 0.087   | 0.413   | Gray  | 100            |
| L438P    | 4 AWG      | 4 - 6 AWG             | 3/8"            | 0.252       | 0.343       | 1.913            | 0.591           | 0.370   | 0.811   | 0.984    | 0.087   | 0.413   | Gray  | 100            |
| L456     | 4 AWG      | 4 - 6 AWG             | 5/16"           | 0.252       | 0.343       | 1.772            | 0.488           | 0.315   | 0.669   | 0.984    | 0.087   | 0.331   | Gray  | 100            |
| L456P    | 4 AWG      | 4 - 6 AWG             | 5/16"           | 0.252       | 0.343       | 1.772            | 0.488           | 0.315   | 0.669   | 0.984    | 0.087   | 0.331   | Gray  | 100            |
| L314     | 3 AWG      | 3 - 6 AWG             | 1/4"            | 0.270       | 0.377       | 2.344            | 0.531           | 0.323   | 0.828   | 1.169    | 0.097   | 0.277   | White | 100            |
| L356     | 3 AWG      | 3 - 6 AWG             | 5/16"           | 0.270       | 0.377       | 2.157            | 0.538           | 0.346   | 0.767   | 1.120    | 0.091   | 0.336   | White | 50             |