

# P851-ICAT 5" NEW CONSTRUCTION RECESSED HOUSING

## Specifications:

### Description:

The P851-ICAT is a 5" IC, airtight, incandescent downlight housing, specifically designed to provide the contractor with the best value downlight.

### Application:

Ideal for new construction, the P851-ICAT can also be used for most light commercial and residential applications where insulated ceilings require an IC rated, line voltage downlight.

### Trim:

Trims use friction springs to attach to housing and provide a snug fit against the ceiling plane.

### Approvals:

UL/CUL Damp Location Listed. IC listed for direct contact with insulation. Airtight tested to ASTM E283 standards. Meets State of Washington and California Title 24 Restricted airflow requirements. Only compatible with P867WL-28, P868-28, P876-28.

### Housing:

Snap-on J-box doors provide easy access for wiring and field inspection. Housing adjusts up to 1" to accommodate different ceiling thicknesses.

### Installation:

Pre-installed bar hangers with locking screws, integral nail, and alignment tab for wood joist construction. Hangers accommodate ceiling joists of up to 24 inches on-center. Captive bar hangers secure housing in place and can be reoriented 90° to housing.

### Lamps:

Housing socket plate adjusts vertically for various lamp sizes. Use with PAR30 or R30 lamp. Lamp supplied by others.

### Electrical:

High temperature porcelain socket with plated brass or copper screw shell. Thermal protector prevents fixture from overheating when improperly installed or over-lamped.

## P851-ICAT

### Images:



### Dimensions:

- A: 14-3/4"
- B: 13-1/4"
- C: 7-1/4"
- D: 5-5/8"

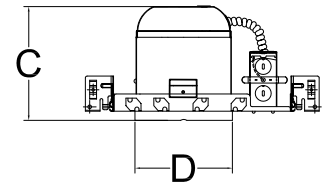
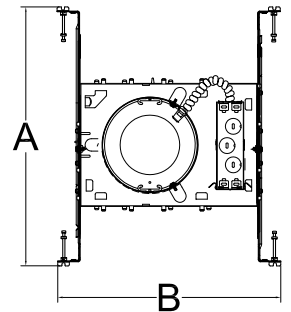

### Trims:



P867WL-28  
PAR30 50W  
White Shower



P868-28  
PAR30/R30 50W  
White Step Baffle



P876-28  
PAR30 75W  
White Eyeball

# P851-ICAT 5" NEW CONSTRUCTION RECESSED HOUSING

## Specifications:

### Description:

The P851-ICAT is a 5" IC, airtight, incandescent downlight housing, specifically designed to provide the contractor with the best value downlight.

### Application:

Ideal for new construction, the P851-ICAT can also be used for most light commercial and residential applications where insulated ceilings require an IC rated, line voltage downlight.

### Trim:

Trims use friction springs to attach to housing and provide a snug fit against the ceiling plane.

### Approvals:

UL/CUL Damp Location Listed. IC listed for direct contact with insulation. Airtight tested to ASTM E283 standards. Meets State of Washington and California Title 24 Restricted airflow requirements. Only compatible with P867WL-28, P868-28, P876-28.

### Housing:

Snap-on J-box doors provide easy access for wiring and field inspection. Housing adjusts up to 1" to accommodate different ceiling thicknesses.

### Installation:

Pre-installed bar hangers with locking screws, integral nail, and alignment tab for wood joist construction. Hangers accommodate ceiling joists of up to 24 inches on-center. Captive bar hangers secure housing in place and can be reoriented 90° to housing.

### Lamps:

Housing socket plate adjusts vertically for various lamp sizes. Use with PAR30 or R30 lamp. Lamp supplied by others.

### Electrical:

High temperature porcelain socket with plated brass or copper screw shell. Thermal protector prevents fixture from overheating when improperly installed or over-lamped.

## P851-ICAT

### Images:



### Dimensions:

- A: 14-3/4"
- B: 13-1/4"
- C: 7-1/4"
- D: 5-5/8"

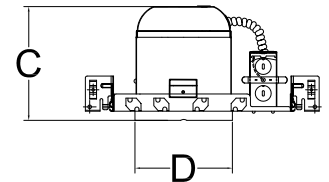
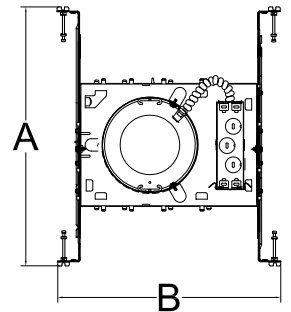

### Trims:



P867WL-28  
PAR30 50W  
White Shower



P868-28  
PAR30/R30 50W  
White Step Baffle



P876-28  
PAR30 75W  
White Eyeball