



## FEATURES & SPECIFICATIONS

**INTENDED USE** — The PS30250 dual-voltage (120V or 277V) emergency LED driver is designed to provide a minimum of 90 minutes of illumination for LED luminaires during the loss of normal AC power. It is UL classified for field installation for specified luminaires and UL recognized for factory installation, providing 30-watts maximum output power, constant current, with two options for loads up to 100 VDC or 250VDC. Option will be configured during installation.

**CONSTRUCTION** — 20-gauge, black steel enclosure.

**PERFORMANCE** — When normal AC power fails, the PS30250 immediately drives the LED load at a reduced light output for a minimum of 90 minutes. When AC power is present, the emergency LED driver operates in various charging modes to ensure the sealed, maintenance-free, high-temperature nickel-cadmium batteries are fully recharged within 48 hours after a discharge and remains fully charged until the next loss of AC power. The pilot light/test switch provides visual and manual means of monitoring the system operation.

### ELECTRICAL

Constant current series resistor-type charger, provides high efficiency and reliable operation.

High efficiency push-pull inverter is the most effective method of converting power. It provides maximum light output, battery life and reliability.

AC/LVD reset allows battery connection before AC power is applied and prevents battery damage from deep discharge.

Dual-volt input capability – 120V or 277V

Output — 100 mA for voltage up to 250 VDC  
250 mA for voltage up to 100 VDC

Maximum Output Power – 30 watts

Maximum AC input (120V) – 92 mA, 9.6 Watts

Maximum AC input (277V) – 41 mA, 10.2 Watts

**BATTERY** — Sealed, maintenance-free, high temperature nickel cadmium battery. Ensures long life over wide temperature ranges. Battery automatically recharges after any discharge.

External battery connectors allow battery pack to be disabled for maintenance and installation.

Pilot light and test switch provide visual and manual means of monitoring system operation. Two 1/2" holes are required to permit mounting of pilot light/test switch in fixture housing.

**INSTALLATION** — Mounts concealed within plenum or on top of fixture housing for improved aesthetics and protection from vandalism. Wiring protected by 18" flexible conduit.

Emergency Driver may be remote mounted up to 50 feet from fixture, or half the distance recommended by the driver manufacturer, whichever is less.

Test switch may be remote mounted up to eight feet from emergency driver. For additional feet refer to the accessories for ordering.

**LISTINGS** — UL recognized. Meets UL 924, NFPA 101 (current Life Safety Code), NEC and OSHA illumination standards.

Standard unit is UL recognized for installation in damp or wet location sealed and gasketed listed luminaires.

Not suitable for mounting outside the luminaire in a wet location application.

Ambient temp ratings 0°C to 50°C (32°F to 122°F).

UL classified for field installation for the Acuity Brands IBG, IBL and IBH fixture families.

**WARRANTY** — 5-year limited warranty. Complete warranty terms located at:

[www.acuitybrands.com/CustomResources/Terms\\_and\\_conditions.aspx](http://www.acuitybrands.com/CustomResources/Terms_and_conditions.aspx)

**Note:** Actual performance may differ as a result of end-user environment and application.

Specifications subject to change without notice.

Catalog Number
Notes
Type

# PS30250

## Constant Current Emergency Driver

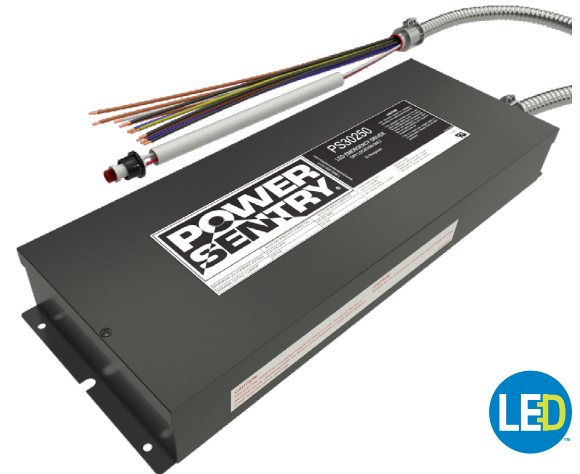

**How to Estimate Delivered Lumens in Emergency Mode**  
Use the formula below to estimate the delivered lumens in emergency mode

**Delivered Lumens = 1.25 x P x LPW**

P = Output power of emergency driver. P = 30W for PS30250  
LPW = Lumen per watt rating of the luminaire. This information is available on the ABL luminaire spec sheet. The LPW rating is also available at [Designlight Consortium](http://Designlight Consortium).

### MOUNTING

All dimensions are in inches.  
Enclosure Length: 15 3/8 inches  
Shipping weight: 10.3 lb (4.7 kg)

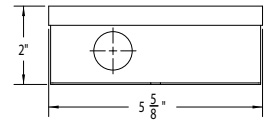

## A+ Capable Component

This product is an A+ enabling component when correctly applied with compatible Acuity Brands' Luminaires.

- This product has been interoperability tested with the luminaire and becomes part of the A+ Certified solution of the luminaire (see luminaire spec sheet for all A+ certified details)
- Field installation for these luminaires is A+ certified and luminaire warranty maintained when installed and wired per instructions

To learn more about A+, visit [www.acuitybrands.com/aplus](http://www.acuitybrands.com/aplus).

### ORDERING INFORMATION

Lead times will vary depending on options selected. Consult with your sales representative.

**Example:** PS30250 FIK

#### PS30250 FIK

#### Series

PS30250 FIK Power Sentry 30W Max Output Wattage 100 or 250VDC Max Output Voltage<sup>1,2</sup>

#### Accessories<sup>3</sup>: Order as separate catalog number.

ELA RTS2 Remote test switch; can be mounted up to 25' away from emergency driver and replaces the standard test switch shipped with the PS30250 FIK

#### Notes

- 1 100VDC/250VDC option set during installation via violet wire connection. See installation instructions for more details.
- 2 Includes installation instruction and plate for field installation.
- 3 See accessories specification sheets for details on other compatible devices: [ELA-RTS-TSPLP-PSTS-PSPRSB](http://ELA-RTS-TSPLP-PSTS-PSPRSB).

# PS30250 LED Emergency Battery Pack

## SPECIFICATIONS

### KEY FEATURES

- Test Switch and Pilot Light
- Selector Wires



Selector wires (violet) not connected.  
Maximum LED forward voltage 250 VDC max  
Nominal output current 100 mA.



Selector wires (violet) connected.  
Maximum LED forward voltage 100 VDC max  
Nominal output current 250 mA.



Pilot Light

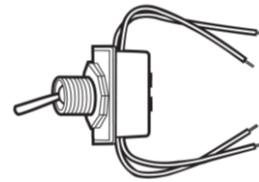

Test Switch

### KEY OPTIONS

- Remote Test Switch ELA RTS2

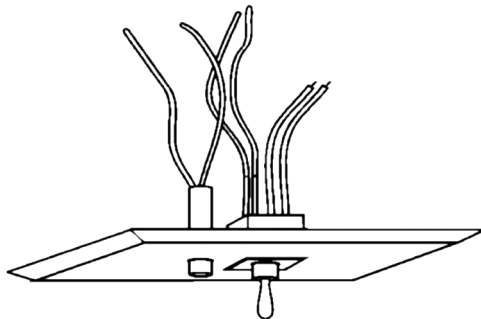

ELA RTS2

