

## Red•Dot® metallic round boxes and covers

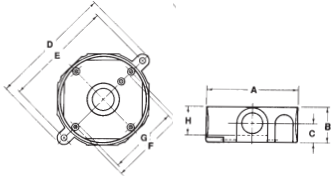

S110CN / S-48 / DS47BR



S-47



Cat. No.	Description	Hub Size (in.)	No. of Hubs	A (in.)	B (in.)	C (in.)	D (in.)	E (in.)	F (in.)	G (in.)	H (in.)	Cu. (in.)
<b>Outlet Boxes – 4-1/8 in. Dia. (Cast Aluminum)</b>												
S110CN*	Round outlet box, 17 Cu. in., silver, aluminum, with ground screws	1/2	5	4-1/8	1-5/8	3/4	5-9/16	4-15/16	3-1/2	3-1/8	1-1/4	16.3
S110BRCN*	Single gang universal standard outlet box, 17.3 Cu. in., bronze, aluminum, with ground screws	1/2	5	4-1/8	1-5/8	3/4	5-9/16	4-15/16	3-1/2	3-1/8	1-1/4	16.3
S110WHCN*	Single gang universal standard outlet box, 17.3 Cu. in., white, aluminum, with ground screws	1/2	5	4-1/8	1-5/8	3/4	5-9/16	4-15/16	3-1/2	3-1/8	1-1/4	16.3
DS-47-BR*	Round outlet box, 17 Cu. in., bronze, aluminum	1/2	5	4-1/8	1-5/8	3/4	5-9/16	4-15/16	3-1/2	3-1/8	1-1/4	16.3
DS-47-WH*	Round outlet box, 17 Cu. in., white, aluminum	1/2	5	4-1/8	1-5/8	3/4	5-9/16	4-15/16	3-1/2	3-1/8	1-1/4	16.3
S-48*	Round outlet box, 16 Cu. in., silver, aluminum	3/4	5	4-1/8	1-5/8	7/8	5-9/16	4-15/16	3-1/2	3-1/8	1-1/4	15.8
S-47	Round outlet box, 17 Cu. in., silver, aluminum	1/2	5	4-1/8	1-5/8	3/4	5-9/16	4-15/16	3-1/2	3-1/8	1-1/4	16.3

\*Raintight with cover closed and when used with appropriate Red Dot® boxes



SE-47 / SE-48

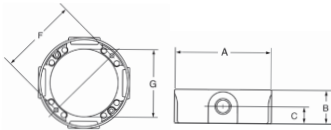

S130E-CN



Cat. No.	Description	Hub Size (in.)	No. of Hubs	A (in.)	B (in.)	C (in.)	F (in.)	G (in.)	Cu. (in.)
<b>Outlet Box Extension – 4-1/8 in. Dia. (Cast Aluminum)</b>									
SE-48*	Round extension ring, grey, aluminum, gaskets and screws	3/4	4	4-1/8	1-5/8	13/16	3-1/2	3-1/16	18.3
S130E-CN	Round extension adapter, silver, aluminum, with ground screws	1/2	4	4-1/8	1-5/8	13/16	3-1/2	3-1/16	18.3

\*Utilisés avec les boîtes Red Dot® appropriées, ces couvercles sont étanches à la pluie lorsque les capuchons sont fermés.



DS47B / DS48B

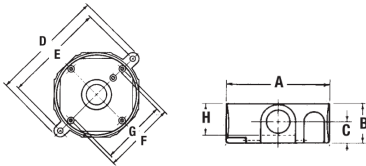

Cat. No.	Description	Hub Size (in.)	No. of Hubs	A (in.)	B (in.)	C (in.)	D (in.)	E (in.)	F (in.)	G (in.)	H (in.)	Cu. (in.)
<b>Outlet Box Kits – 4-1/8 in. Dia. (Cast Aluminum)</b>												
DS-47B*	Round outlet box, silver, aluminum, blank cover	1/2	5	4-1/8	2	7/8	5-9/16	4-15/16	3-1/2	3-1/8	1-1/4	17
S47CFB	Ceiling fan outlet box, silver, aluminum	1/2	5	4-1/8	2	7/8	5-9/16	4-15/16	3-1/2	3-1/8	1-1/4	17
DS-48B*	Round outlet box, silver, aluminum, blank cover	3/4	5	4-1/8	2	7/8	5-9/16	4-15/16	3-1/2	3-1/8	1-1/4	17

\*Raintight with cover closed and when used with appropriate Red Dot® boxes  
See page B27 for close-up plugs. Cover included

## Red•Dot® metallic round boxes and covers



S341E-R



SS-B



S-12 / S211BRE



S213E-R

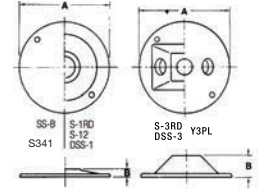

Cat. No.	Description	Hub Size (in.)	No. of Hubs	A (in.)	B (in.)
<b>Outlet Covers – 4-1/8 in. Dia. (Cast Aluminum)</b>					
S341E-R	Round blank weatherproof box cover, color silver	-	-	4-1/8	3/64
SS-B	Round blank weatherproof cover, silver, aluminum, with gasket and screws	-	-	4-1/8	3/64
S211E	Round standard lamp holder cover, silver, aluminum,	1/2	1	4-1/8	3/8
S211BRE	Round standard lamp holder cover, bronze, aluminium	1/2	1	4-1/8	3/8
S211WHE	Round standard lamp holder cover, white, aluminium	1/2	1	4-1/8	3/8
S-12*	Round standard lamp holder cover, silver, aluminum	3/4	1	4-1/8	3/8
S213E-R	Round standard lamp holder cover, Silver, aluminum, with gasket, screws and plugs	1/2	3	4-1/8	1-1/16
S213BRE	Round standard lamp holder cover, Bronze, aluminum, with gasket, screws and plugs	1/2	3	4-1/8	1-1/16
S213WHE	Round standard lamp holder cover, white, aluminum, with gasket, screws and plugs	1/2	3	4-1/8	1-1/16

\* Not CSA Certified



PLG-1-RD / PLG-2-RD / PLG-3-RD



S603E-R / S603BRE-R / S603WHE-R



Cat. No.	Colour	Size (in.)	Description
<b>Plugs</b>			
PLG-1-RD	Silver	1/2	Close-up plugs
PLG-2-RD	Silver	3/4	Close-up plugs
PLG-3-RD	Silver	1	Close-up plugs
S603E-R	Silver	1/2	Close-up plugs Bag/4
S603BRE-R	Bronze	1/2	Close-up plugs Bag/4
S603WHE-R	White	1/2	Close-up plugs Bag/4