

# Pan-Way® Twin-70 Surface Raceway System

# PANDUIT®

SPECIFICATION SHEET

## specifications

Twin-70 non-metallic, multi-channel surface raceway is used to route, protect, and conceal data, voice, fiber optic, and power cabling. The raceway is listed as suitable for use in applications up to 600 volts between connectors when screw secured and installed per instructions. A full complement of fittings with a 1" minimum bend radius is available as well as device brackets and internal junction boxes to install a variety of communication and electrical devices. The raceway provides two separate covers to maintain total separation of power and low voltage cabling. The Twin-70 raceway finish is pure in color and will resist scratches and dents, and will not peel or corrode. Twin-70 raceway is available in three standard colors and is optimized for use with the Panduit® Pan-Net® Communication System.

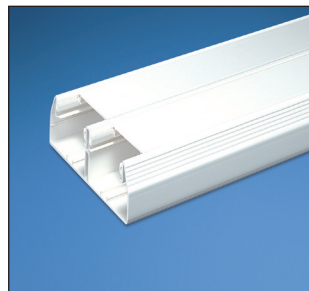

## technical information

<b>Material:</b>	Rigid PVC
<b>Flammability:</b>	UL94V-0; FT4
<b>Voltage rating:</b>	UL 600V / CSA 600V
<b>Safety compliance:</b>	UL Listed 95425 (raceway); UL Listed E116129 (fittings)
<b>NEC:</b>	Article 388
<b>Capacity:</b>	Multi-channel
<b>Operating and storage temperature:</b>	0° to 50°C

## key features and benefits

<b>Separate covers throughout the system</b>	Maintains complete separation of power and data cabling systems and provides maximum safety during installation for moves, adds, and changes
<b>1" bend radius control fittings</b>	Cables in the raceway will satisfy the minimum 1" bend radius requirement, preventing the potential degradation of cable performance
<b>Snap-on faceplates</b>	Faceplates snap directly onto the raceway base; cabling can be quickly accessed by removing only the faceplate, requiring less labor and lowers the cost of maintenance
<b>Designer profile</b>	Maintains the same aesthetically pleasing profile of Panduit T-45, T-70, and TG-70 raceway which allows all four systems to work together or independently
<b>Non-metallic</b>	Lightweight, reducing installer fatigue and labor required to install the raceway. Easy to cut with standard saws and saw blades, eliminating the need for special cutting devices
<b>Available in different lengths, and colors</b>	Available lengths – 8', 10' Available colors – IW, EI, WH Raceway is field paintable to match walls and surrounding décor.

## applications

Pan-Way® Twin-70 Surface Raceways are designed to provide easy and economical solutions for routing power and low voltage cable in independent channels along perimeter walls, baseboards or ceilings.

This raceway is a perfect solution for schools, hospitals, offices or anywhere high cable capacity is required.

### Pan-Way® Twin-70 Raceway

#### Raceway Bases

<b>8 feet:</b>	T702BIW8
<b>10 feet:</b>	T702BIW10

#### Raceway Covers

<b>8 feet:</b>	T70CIW8
<b>10 feet:</b>	T70CIW10

#### Divider Walls

<b>8 feet:</b>	T70DW8
<b>10 feet:</b>	T70DW10

### Twin-70 Raceway Fittings

<b>Base coupler:</b>	T702BCIW-X
<b>Cover coupler:</b>	T70CCIW-X
<b>Outside corner:</b>	T702OCIW
<b>Inside corner:</b>	T702ICIW
<b>Right angle:</b>	T702RAIW
<b>End cap:</b>	T702ECIW
<b>Entrance end:</b>	T702EEIW
<b>Tee fitting:</b>	T702TIW
<b>Transition to T-70:</b>	T702TRIW
<b>Transition to LD/T-45:</b>	T702TRLIW
<b>Transition divider insert:</b>	T702TRI

### Twin-70 Accessories

<b>Wire retainer:</b>	T70WR-X
<b>Device bracket:</b>	T70DB-X
<b>Standard faceplate bracket:</b>	T70SDB-X
<b>Three sided hanging box:</b>	T70HB3-X
<b>GFCI three sided hanging box:</b>	T70HB3GFCI-X
<b>Hanging box:</b>	T70HB-X
<b>Spacer plate:</b>	T70S-X
<b>Fiber spool bracket:</b>	T70FSB

For standard colors other than IW (Off White), replace IW in part number with EI (Electrical Ivory) or WH (White).

# Pan-Way® Twin-70 Surface Raceway System

## Wire Fill

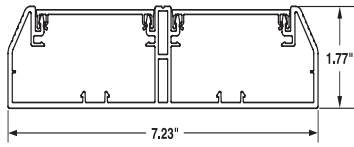

TWIN-70  
Left Internal Area = 4.59 Sq. In.  
Right Internal Area = 4.59 Sq. In.

Raceway Type and Configuration	Fill Area (in <sup>2</sup> )	Electrical Cables			Data Grade Cables								Coax Cables				Fiber Optic Cable	
		14 AWG	12 AWG	10 AWG	24 AWG		23 AWG		26 AWG		23 AWG		RG6		RG59/u		2 Strand	
		THHN/THWN/T90			Cat. 5e		Cat. 6		Cat. 6A (SD)		Cat. 6A							
		0.111	0.130	0.164	DIA = 0.193		DIA = 0.240		DIA = 0.240		DIA = 0.300		DIA = 0.275		DIA = 0.242		DIA = 0.175	
		FILL			FILL		FILL		FILL		FILL		FILL		FILL		FILL	
		MAX	MAX	MAX	SPEC	MAX	SPEC	MAX	SPEC	MAX	SPEC	MAX	SPEC	MAX	SPEC	MAX	SPEC	MAX
(UL Temp Rise Test)			(40%) (60%)		(40%) (60%)		(40%) (60%)		(40%) (60%)		(40%) (60%)		(40%) (60%)		(40%) (60%)		(40%) (60%)	
Twin-70: Power and data (no terminations)	2.05	—	—	—	28	42	18	27	18	27	11	17	13	20	17	26	34	51
	1.43	16	16	15	—	—	—	—	—	—	—	—	—	—	—	—	—	—
Twin-70: One channel (no devices)	4.59	—	—	—	62	94	40	60	40	60	25	38	30	46	39	59	76	114
Twin-70: Data only (Screw-On Faceplate)	3.11	—	—	—	42	63	27	41	27	41	17	26	20	31	27	40	51	77
Twin-70: Power only (Screw-On Faceplate)	3.32	15	13	13	—	—	—	—	—	—	—	—	—	—	—	—	—	—
Twin-70: Data only (Snap-On Faceplate)	4.14	—	—	—	56	84	36	54	36	54	23	35	27	41	36	54	68	103
Twin-70: TVSS Power (Snap-On Faceplate)	2.33	16	16	14	—	—	—	—	—	—	—	—	—	—	—	—	—	—

Note: Cable diameters shown are industry averages and not necessarily Panduit specific, except for Cat. 6A (SD).

## Twin-70 Lineart

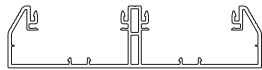

T702B



T70C

# Pan-Way® Twin-70 Surface Raceway System

## Fittings and Accessories

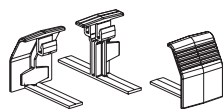

T702BC-X

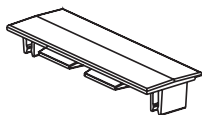

T70CC-X

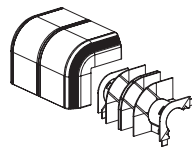

T702OC

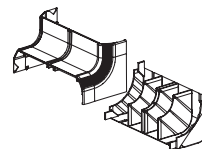

T702IC

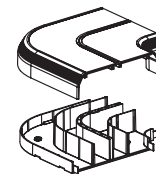

T702RA

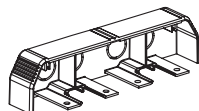

T702EC

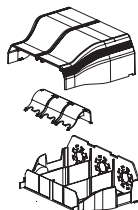

T702EE

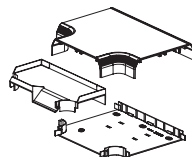

T702T

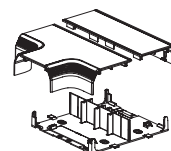

T702TR

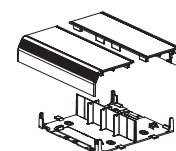

T702TRL

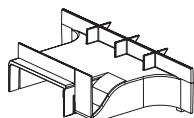

T702TRI

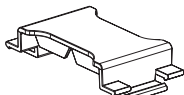

T70WR-X

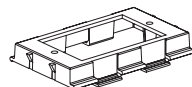

T70DB-X

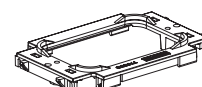

T70SDB-X

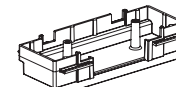

T70HB3-X

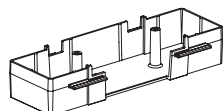

T70HB3GFCI-X

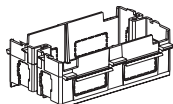

T70HB-X

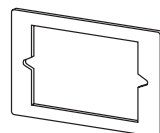

T70S-X



T70FSB

### WORLDWIDE SUBSIDIARIES AND SALES OFFICES

PANDUIT CANADA  
Markham, Ontario  
cs-cdn@panduit.com  
Phone: 800.777.3300

PANDUIT EUROPE LTD.  
London, UK  
cs-emea@panduit.com  
Phone: 44.20.8601.7200

PANDUIT SINGAPORE PTE. LTD.  
Republic of Singapore  
cs-ap@panduit.com  
Phone: 65.6305.7575

PANDUIT JAPAN  
Tokyo, Japan  
cs-japan@panduit.com  
Phone: 81.3.6863.6000

PANDUIT LATIN AMERICA  
Guadalajara, Mexico  
cs-la@panduit.com  
Phone: 52.33.3777.6000

PANDUIT AUSTRALIA PTY. LTD.  
Victoria, Australia  
cs-aus@panduit.com  
Phone: 61.3.9794.9020

For a copy of Panduit product warranties, log on to [www.panduit.com/warranty](http://www.panduit.com/warranty)

For more information

Visit us at [www.panduit.com](http://www.panduit.com)

Contact Customer Service by email: [cs@panduit.com](mailto:cs@panduit.com)  
or by phone: 800.777.3300

©2015 Panduit Corp.  
ALL RIGHTS RESERVED.  
SRSP28--WW-ENG  
Replaces WW-SRSP09  
06/2016

# PANDUIT®

# Pan-Way® Twin-70 Surface Raceway System

# PANDUIT®

SPECIFICATION SHEET

## specifications

Twin-70 non-metallic, multi-channel surface raceway is used to route, protect, and conceal data, voice, fiber optic, and power cabling. The raceway is listed as suitable for use in applications up to 600 volts between connectors when screw secured and installed per instructions. A full complement of fittings with a 1" minimum bend radius is available as well as device brackets and internal junction boxes to install a variety of communication and electrical devices. The raceway provides two separate covers to maintain total separation of power and low voltage cabling. The Twin-70 raceway finish is pure in color and will resist scratches and dents, and will not peel or corrode. Twin-70 raceway is available in three standard colors and is optimized for use with the Panduit® Pan-Net® Communication System.

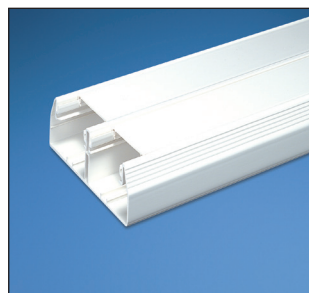

## technical information

<b>Material:</b>	Rigid PVC
<b>Flammability:</b>	UL94V-0; FT4
<b>Voltage rating:</b>	UL 600V / CSA 600V
<b>Safety compliance:</b>	UL Listed 95425 (raceway); UL Listed E116129 (fittings)
<b>NEC:</b>	Article 388
<b>Capacity:</b>	Multi-channel
<b>Operating and storage temperature:</b>	0° to 50°C

## key features and benefits

<b>Separate covers throughout the system</b>	Maintains complete separation of power and data cabling systems and provides maximum safety during installation for moves, adds, and changes
<b>1" bend radius control fittings</b>	Cables in the raceway will satisfy the minimum 1" bend radius requirement, preventing the potential degradation of cable performance
<b>Snap-on faceplates</b>	Faceplates snap directly onto the raceway base; cabling can be quickly accessed by removing only the faceplate, requiring less labor and lowers the cost of maintenance
<b>Designer profile</b>	Maintains the same aesthetically pleasing profile of Panduit T-45, T-70, and TG-70 raceway which allows all four systems to work together or independently
<b>Non-metallic</b>	Lightweight, reducing installer fatigue and labor required to install the raceway. Easy to cut with standard saws and saw blades, eliminating the need for special cutting devices
<b>Available in different lengths, and colors</b>	Available lengths – 8', 10' Available colors – IW, EI, WH Raceway is field paintable to match walls and surrounding décor.

## applications

Pan-Way® Twin-70 Surface Raceways are designed to provide easy and economical solutions for routing power and low voltage cable in independent channels along perimeter walls, baseboards or ceilings.

This raceway is a perfect solution for schools, hospitals, offices or anywhere high cable capacity is required.

## Pan-Way® Twin-70 Raceway

### Raceway Bases

<b>8 feet:</b>	T702BIW8
<b>10 feet:</b>	T702BIW10

### Raceway Covers

<b>8 feet:</b>	T70CIW8
<b>10 feet:</b>	T70CIW10

### Divider Walls

<b>8 feet:</b>	T70DW8
<b>10 feet:</b>	T70DW10

## Twin-70 Raceway Fittings

<b>Base coupler:</b>	T702BCIW-X
<b>Cover coupler:</b>	T70CCIW-X
<b>Outside corner:</b>	T702OCIW
<b>Inside corner:</b>	T702ICIW
<b>Right angle:</b>	T702RAIW
<b>End cap:</b>	T702ECIW
<b>Entrance end:</b>	T702EEIW
<b>Tee fitting:</b>	T702TIW
<b>Transition to T-70:</b>	T702TRIW
<b>Transition to LD/T-45:</b>	T702TRLIW
<b>Transition divider insert:</b>	T702TRI

## Twin-70 Accessories

<b>Wire retainer:</b>	T70WR-X
<b>Device bracket:</b>	T70DB-X
<b>Standard faceplate bracket:</b>	T70SDB-X
<b>Three sided hanging box:</b>	T70HB3-X
<b>GFCI three sided hanging box:</b>	T70HB3GFCI-X
<b>Hanging box:</b>	T70HB-X
<b>Spacer plate:</b>	T70S-X
<b>Fiber spool bracket:</b>	T70FSB

For standard colors other than IW (Off White), replace IW in part number with EI (Electrical Ivory) or WH (White).

# Pan-Way® Twin-70 Surface Raceway System

## Wire Fill

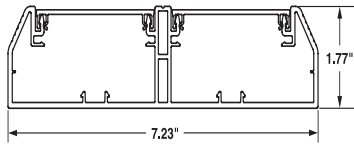

TWIN-70  
Left Internal Area = 4.59 Sq. In.  
Right Internal Area = 4.59 Sq. In.

Raceway Type and Configuration	Fill Area (in <sup>2</sup> )	Electrical Cables			Data Grade Cables								Coax Cables				Fiber Optic Cable	
		14 AWG	12 AWG	10 AWG	24 AWG		23 AWG		26 AWG		23 AWG		RG6		RG59/u		2 Strand	
		THHN/THWN/T90			Cat. 5e		Cat. 6		Cat. 6A (SD)		Cat. 6A							
		0.111	0.130	0.164	DIA = 0.193		DIA = 0.240		DIA = 0.240		DIA = 0.300		DIA = 0.275		DIA = 0.242		DIA = 0.175	
		FILL			FILL		FILL		FILL		FILL		FILL		FILL		FILL	
		MAX	MAX	MAX	SPEC	MAX	SPEC	MAX	SPEC	MAX	SPEC	MAX	SPEC	MAX	SPEC	MAX	SPEC	MAX
(UL Temp Rise Test)			(40%) (60%)		(40%) (60%)		(40%) (60%)		(40%) (60%)		(40%) (60%)		(40%) (60%)		(40%) (60%)		(40%) (60%)	
Twin-70: Power and data (no terminations)	2.05	—	—	—	28	42	18	27	18	27	11	17	13	20	17	26	34	51
	1.43	16	16	15	—	—	—	—	—	—	—	—	—	—	—	—	—	—
Twin-70: One channel (no devices)	4.59	—	—	—	62	94	40	60	40	60	25	38	30	46	39	59	76	114
Twin-70: Data only (Screw-On Faceplate)	3.11	—	—	—	42	63	27	41	27	41	17	26	20	31	27	40	51	77
Twin-70: Power only (Screw-On Faceplate)	3.32	15	13	13	—	—	—	—	—	—	—	—	—	—	—	—	—	—
Twin-70: Data only (Snap-On Faceplate)	4.14	—	—	—	56	84	36	54	36	54	23	35	27	41	36	54	68	103
Twin-70: TVSS Power (Snap-On Faceplate)	2.33	16	16	14	—	—	—	—	—	—	—	—	—	—	—	—	—	—

Note: Cable diameters shown are industry averages and not necessarily Panduit specific, except for Cat. 6A (SD).

## Twin-70 Lineart

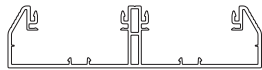

T702B



T70C

# Pan-Way® Twin-70 Surface Raceway System

## Fittings and Accessories

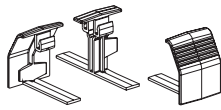

T702BC-X

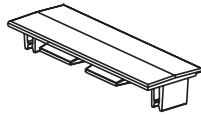

T70CC-X

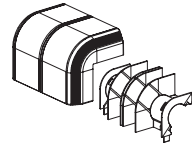

T702OC

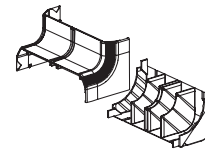

T702IC

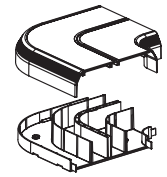

T702RA

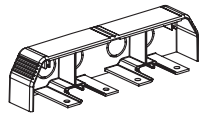

T702EC

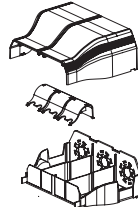

T702EE

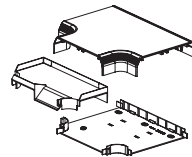

T702T

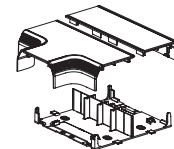

T702TR

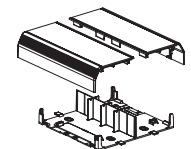

T702TRL

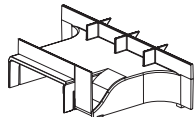

T702TRI

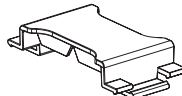

T70WR-X

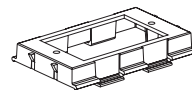

T70DB-X

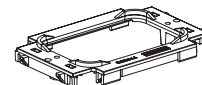

T70SDB-X

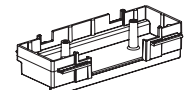

T70HB3-X

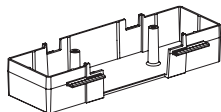

T70HB3GFCI-X

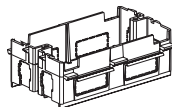

T70HB-X

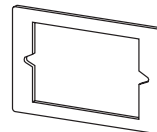

T70S-X

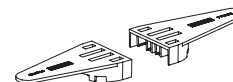

T70FSB

### WORLDWIDE SUBSIDIARIES AND SALES OFFICES

PANDUIT CANADA  
Markham, Ontario  
cs-cdn@panduit.com  
Phone: 800.777.3300

PANDUIT EUROPE LTD.  
London, UK  
cs-emea@panduit.com  
Phone: 44.20.8601.7200

PANDUIT SINGAPORE PTE. LTD.  
Republic of Singapore  
cs-ap@panduit.com  
Phone: 65.6305.7575

PANDUIT JAPAN  
Tokyo, Japan  
cs-japan@panduit.com  
Phone: 81.3.6863.6000

PANDUIT LATIN AMERICA  
Guadalajara, Mexico  
cs-la@panduit.com  
Phone: 52.33.3777.6000

PANDUIT AUSTRALIA PTY. LTD.  
Victoria, Australia  
cs-aus@panduit.com  
Phone: 61.3.9794.9020

For a copy of Panduit product warranties, log on to [www.panduit.com/warranty](http://www.panduit.com/warranty)

For more information

Visit us at [www.panduit.com](http://www.panduit.com)

Contact Customer Service by email: [cs@panduit.com](mailto:cs@panduit.com)  
or by phone: 800.777.3300

**PANDUIT®**

©2015 Panduit Corp.  
ALL RIGHTS RESERVED.  
SRSP28--WW-ENG  
Replaces WW-SRSP09  
06/2016